

# PRONTO-Si

0.3 nW - 800 mW power probe with touchscreen controls

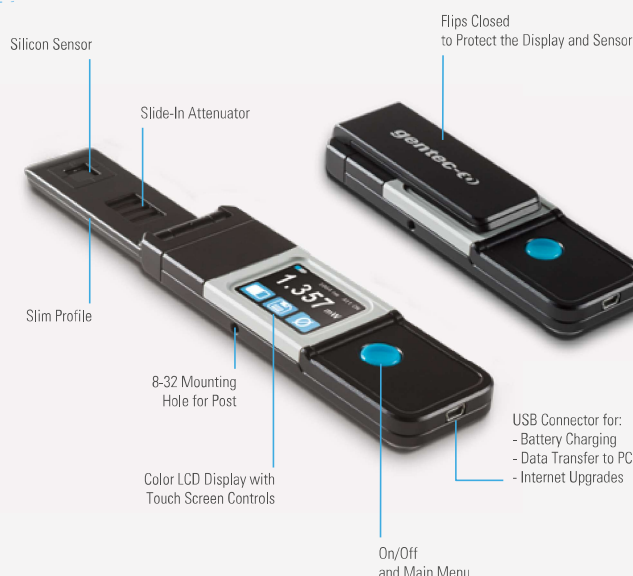

## KEY FEATURES

- **POCKET-SIZE**  
This low power laser probe is so compact it fits in your pocket!
- **SLIM PROFILE**  
The sensor part is only 6 mm thick, allowing it to fit into tight spaces
- **EASY TO USE**  
The color LCD touchscreen allows for a friendly user interface. You can make a measurement with just the touch of a button!
- **VERY LOW POWER MEASUREMENTS**  
Thanks to its very low noise level of only 10 pW, the PRONTO-Si measures powers as low as 0.3 nW
- **SLIDE-IN ATTENUATOR**  
Just slide the OD1 integrated filter to the ON position and you can measure up to 800 mW of continuous power at 532 nm (maximum power varies with wavelength)
- **DATA LOGGING**  
Save your data to the internal memory and then transfer them to your PC over the USB connection
- **OPTIONAL FIBER OPTICS ADAPTOR**  
The fiber optics adaptor is held securely in place with a set screw and is compatible with OD attenuators
- **SERIAL COMMANDS**  
Serial commands are available to let you take full control of your PRONTO from your PC.

## USER INTERFACE

### 3 Displays for the Measurements

Real-Time Display	Bargraph Display	Min/Max Display
<p>Displays the measured value with large digits so you can see them from a distance</p>	<p>Adds a bargraph below the measured value, for an intuitive understanding of the trend of your laser</p>	<p>In addition to the Real Time value, the device displays the lowest and highest values</p>
<b>Save your Data and Transfer it to your PC</b>	<b>Adjust the Wavelength</b>	<b>Set the Brightness and Orientation</b>
<p>Buttons: Save, Print, Erase</p>	<p>Buttons: Wavelength, Confirm, Back</p>	<p>Buttons: Brightness, Orientation, Wavelength, Info</p>

## SLIDE-IN ATTENUATOR



ON - 800 mW



OFF - 80 mW

## DATA TRANSFER TO PC



# PRONTO-SI

## Specifications

CE NIST\*  
Traceable  
\*Also traceable to NRC-CNRC



PRONTO-SI	
<b>MAX AVERAGE POWER*</b> (ATTENUATOR OFF / ATTENUATOR ON)	88mW / 800mW
<b>EFFECTIVE APERTURE</b>	10x10mm
<b>INTERFACE</b>	Touchscreen color LCD display

### MEASUREMENT CAPABILITY

Calibrated spectral range	
Attenuator OFF	320-1100 nm
Attenuator ON	400-1100 nm
Power range*	
Attenuator OFF	0.3 nW - 88 mW at 532 nm
Attenuator ON	3 nW-800 mW at 532 nm
Noise equivalent power	10 pW at 980 nm
Response time	0.25
Measurement accuracy	From ± 15% to ± 75% (wavelength-dependent)
Display resolution	1pW

### DAMAGE THRESHOLDS

Maximum average power density	100W/cm²
Maximum average power	800 mW (with attenuator ON)

### USER INTERFACE

Displays	Real-time, bar graph and min/max
Measurement controls	Zero offset, wavelength selection and reset data
Data acquisition and transfer	Yes

### GENERAL SPECIFICATIONS

Display type	Touchscreen Color LCD
Display size	28.0 x 35.0 mm (128 x 160 pixels)
Data storage	50 000 pts
Battery type	Rechargeable Li-ion
Battery life	17 hours (with brightness set at 25%)
Battery recharge via	USB port

### PHYSICAL CHARACTERISTICS

Effective aperture	10x10mm
Sensor	Silicon
Attenuator	Integrated slide-in ODI attenuator
Mounting hole (for post)	1 X 8-32
Dimensions (Open)	41.0W x 212.0L x 15.0D mm (Sensor part is only 60D mm)
Dimensions (Closed)	41.0W x 134.0L x 21.5D mm
Weight	150g

### ORDERING INFORMATION

Compatible stand	STAND-5-233
Product page	

\* See curves (page 65) for maximum power at other wavelengths

Specifications are subject to change without notice  
T 418.651.8003 | info@gentec-eo.com

gentec-EO

PRODUCT GUIDE 2022

**PHOTO  
TECHNICA** フォトテクニカ株式会社

〒336-0017 埼玉県さいたま市南区南浦和 1-2-17  
TEL: 048-871-0067 FAX: 048-871-0068  
<https://www.phototechnica.co.jp>  
e-mail: voc@phototechnica.co.jp

POWER DETECTORS

ENERGY METERING

HEAT FLOW METER

TELEVISION MONITORING

ON-BOARD THERMISTORS

COMBINATION THERMISTORS